

9000 Pressure Balanced Thermostatic Mixer

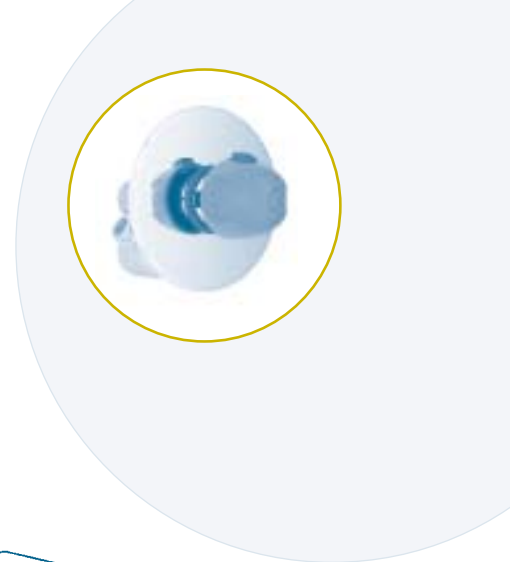

Always close the main supply valve before maintenance (service). (Except for when calibration of temperature is performed).

See following illustrations.

FUNCTION CONTROLS

For mixers with swivel spout, the diverter is located under the mixer, between the body and the spout.

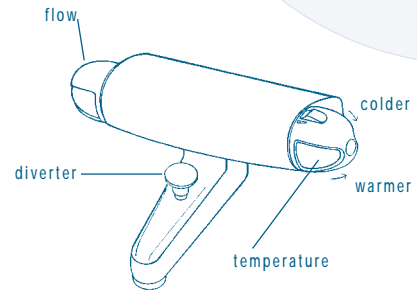

TEMPERATURE CALIBRATION

When the Temperature knob is turned against the stop (as far as possible without pressing the override button), the mixed water should be suitable for shower and bath (appr. 38°C). The mixers are delivered with the stop limit set at 38°C (100°F). If the mixed water temperature is either too hot or too cold at this knob position, the mixer should be recalibrated.

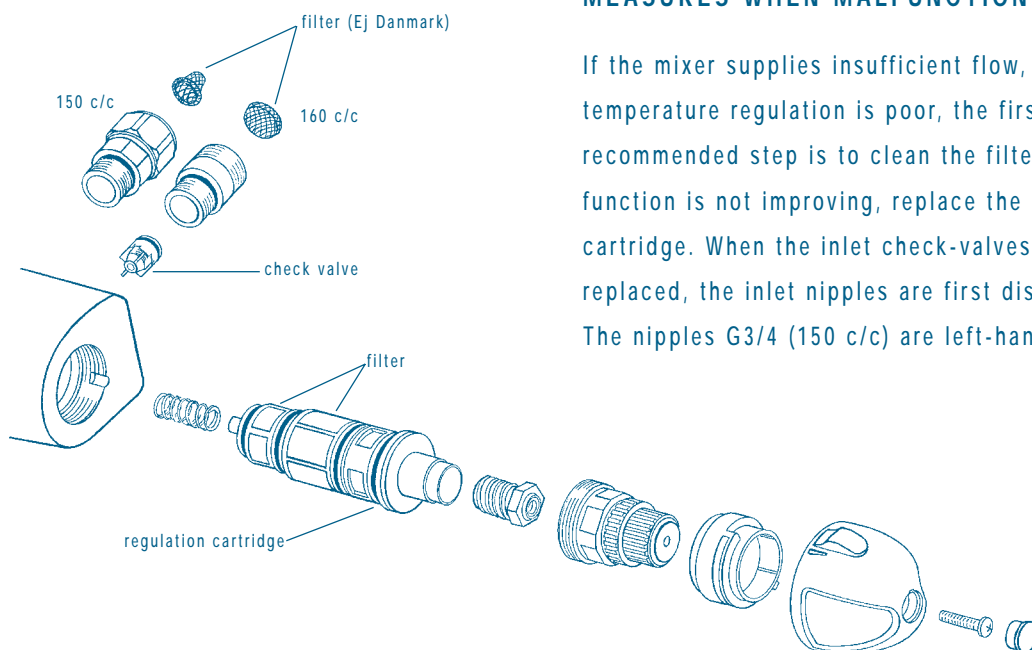
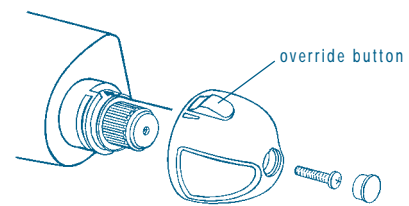

MEASURES WHEN MALFUNCTION OCCURS

If the mixer supplies insufficient flow, or if the temperature regulation is poor, the first recommended step is to clean the filters. If the function is not improving, replace the T/P cartridge. When the inlet check-valves are replaced, the inlet nipples are first dismantled. The nipples G3/4 (150 c/c) are left-hand threaded.

40C/C MIXERS

The check-valves are located in the inlet nipples. The nipples are dismantled with a 10 mm hex socket wrench.

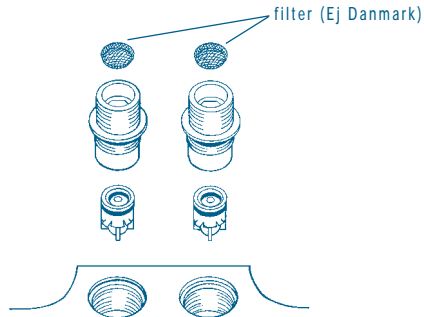

DISMOUNTING AND ATTACHING THE T/P CARTRIDGE HEAD PIECE

Press the spindle and hold it, not allowing it to rotate, when the head piece is threaded on/off.

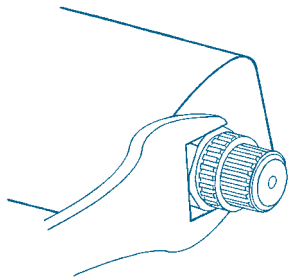

PACKING (TAP DISC) REPLACEMENT

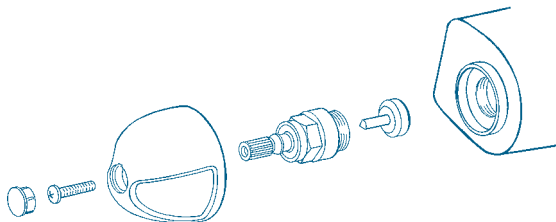

HAND-SHOWER HOLDER

A hand-shower holder is available for the mixer. It is attached to the outlet, between the mixer and the hose.

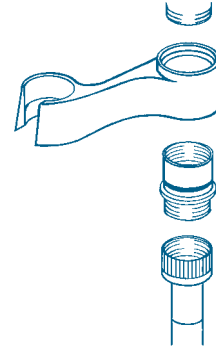

CLEANING

The mixers are best preserved by regular cleaning with a soft cloth and a soap solution, followed by rinsing with clean water and polished with a soft dry cloth. Never use lime dissolvents, acidified or abrasive detergents. For removal of lime spots use vinegar before washing with water. The epoxy coated mixers are not to be exposed to acetone or caustic solution.

Cleaning the aerator

Unscrew the aerator every now and then and clean the insert from impurities. If the insert has lime deposits, wash in vinegar solution.

Approved by

Quality Assurance Services, Australia

Australian Standard - AS 4032-1995

Licence No: 1186